

PINNACLE 6 FT TABLE INSTRUCTIONS

REV.#1 12/6/22

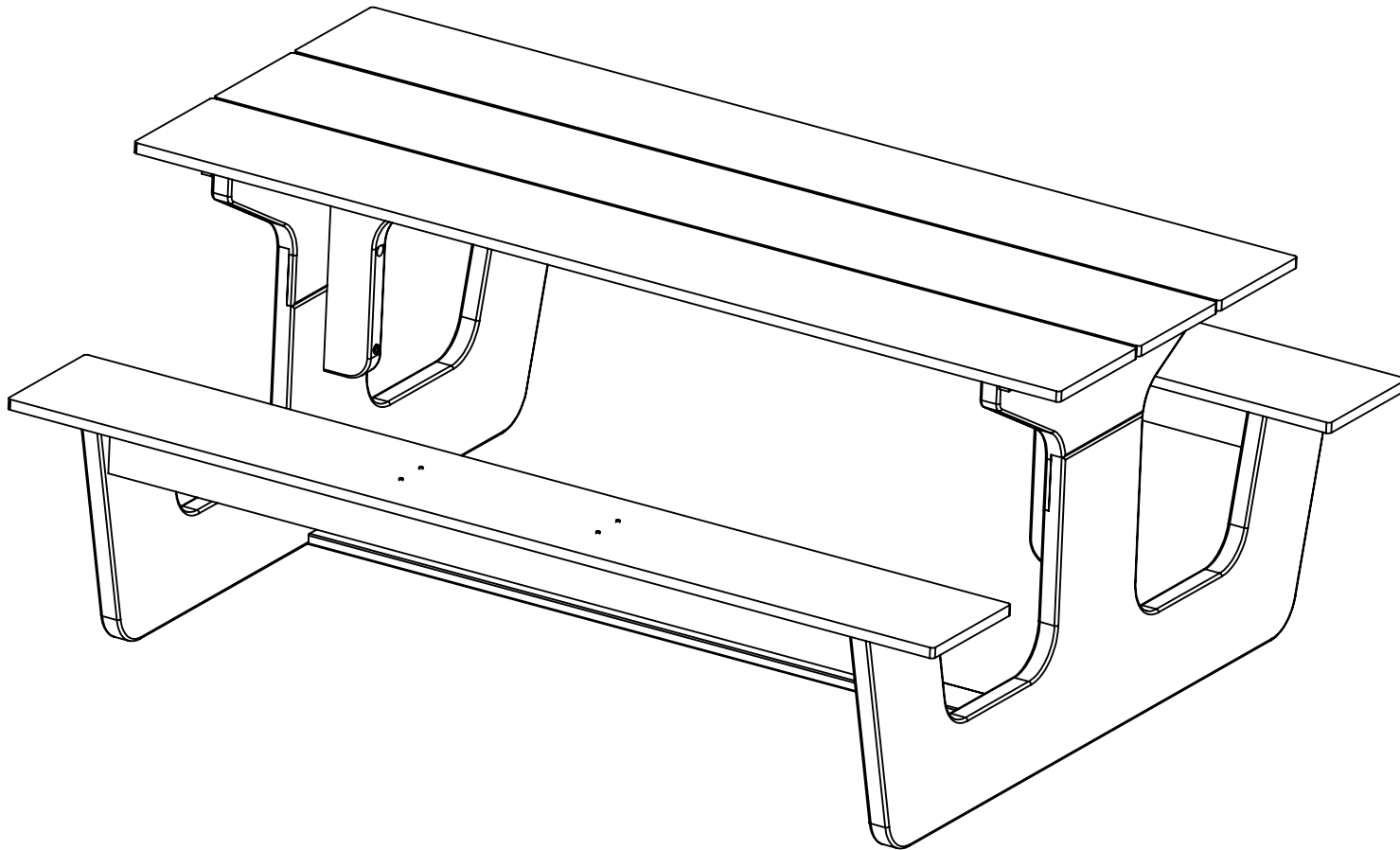

PINNACLE 6 FT TABLE INSTRUCTIONS

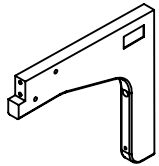

QTY. 2
P/N ATB-P0203 (A)

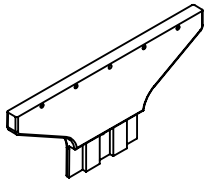

QTY. 2
P/N ATB-P0186 (B)

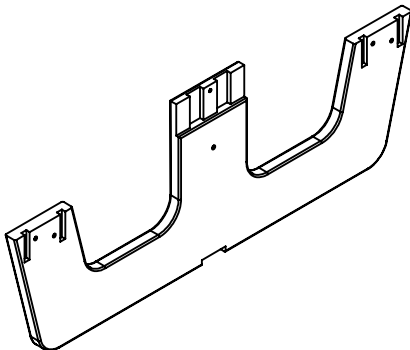

QTY. 2
P/N ATB-P0185 (C)

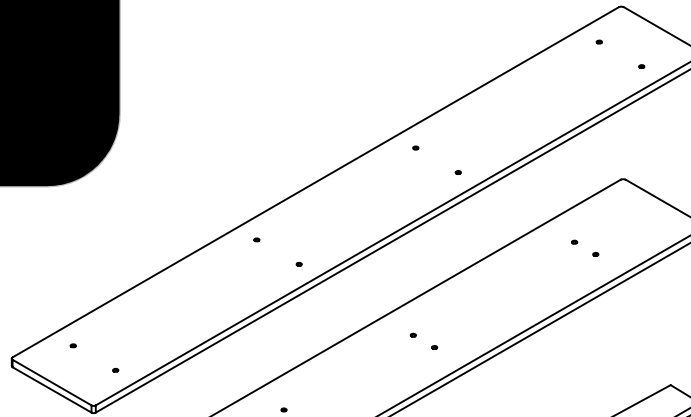

QTY. 3
P/N ATB-P0190 (D)

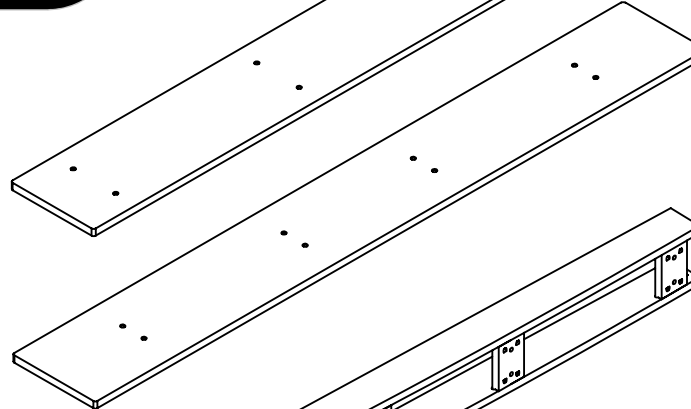

QTY. 2
P/N ATB-P0189 (E)

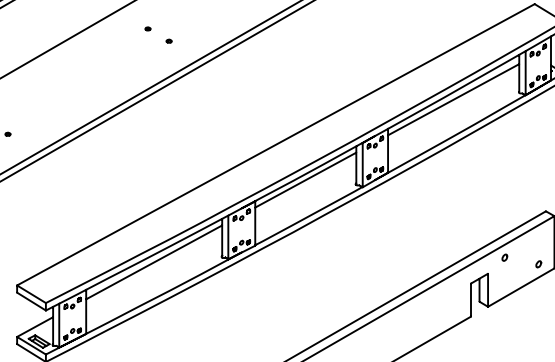

QTY. 2
P/N ATB-A0067 (F)

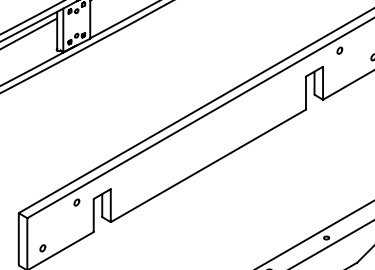

QTY. 2
P/N ATB-P0193 (G)

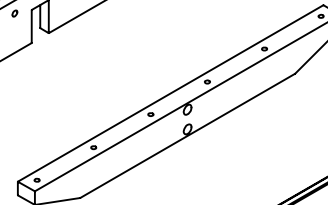

QTY. 2
P/N ATB-P0188 (H)

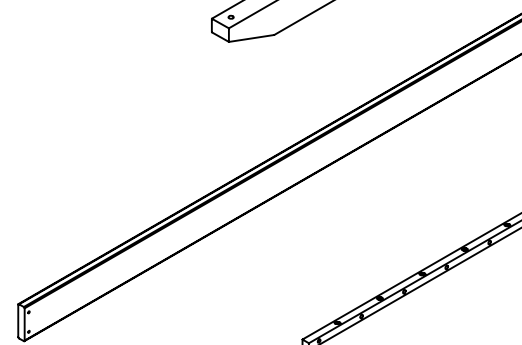

QTY. 1
P/N ATB-P0192 (J)

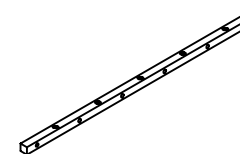

QTY. 2
P/N ATB-P0195 (R)

REQUIRED TOOLS (NOT INCLUDED)

- 1 - 9/16" WRENCH
- 1 - 9/16" SOCKET
- 1 - RUBBER Mallet
- 1 - #2 SQUARE DRIVE BIT
- 1 - 6mm ALLEN WRENCH

**PARTS
REQUIRED**

2/11

PINNACLE 6FT TABLE INSTRUCTIONS

QTY. 4
3/8" X 3-1/2" HEX BOLT

(K)

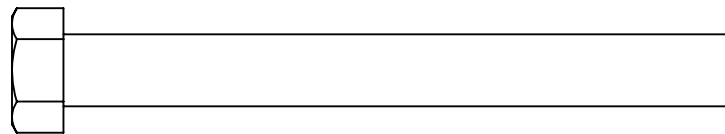

QTY. 8
3/8" FLAT WASHER

(L)

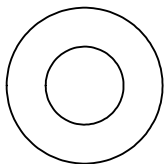

QTY. 4
3/8" LOCKING NUT

(M)

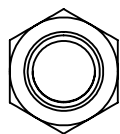

QTY. 66
1/4" FLAT WASHER

(N)

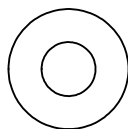

QTY. 60
1/4"-20 x 1-1/4", BUTTON
HEAD MACHINE SCREW

(P)

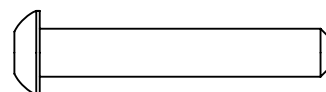

QTY. 4
1/4"-20 x 4", BUTTON
HEAD MACHINE SCREW

(Q)

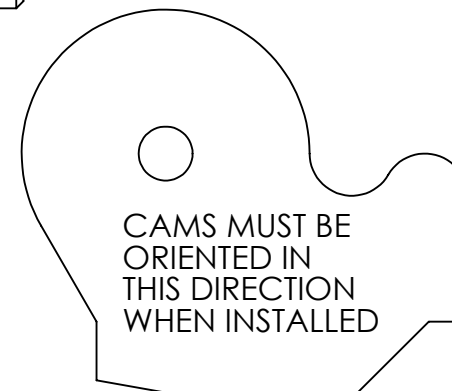
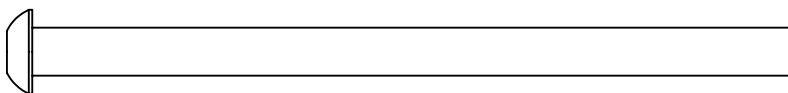

(S)

QTY. 8
CAM

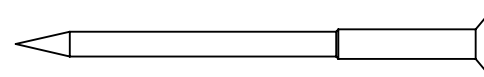

(T)

QTY. 4
DECK SCREW

(R)

QTY. 2
1/4"-20 x 3", BUTTON
HEAD MACHINE SCREW

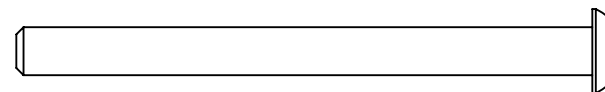

PINNACLE 6 FT TABLE INSTRUCTIONS

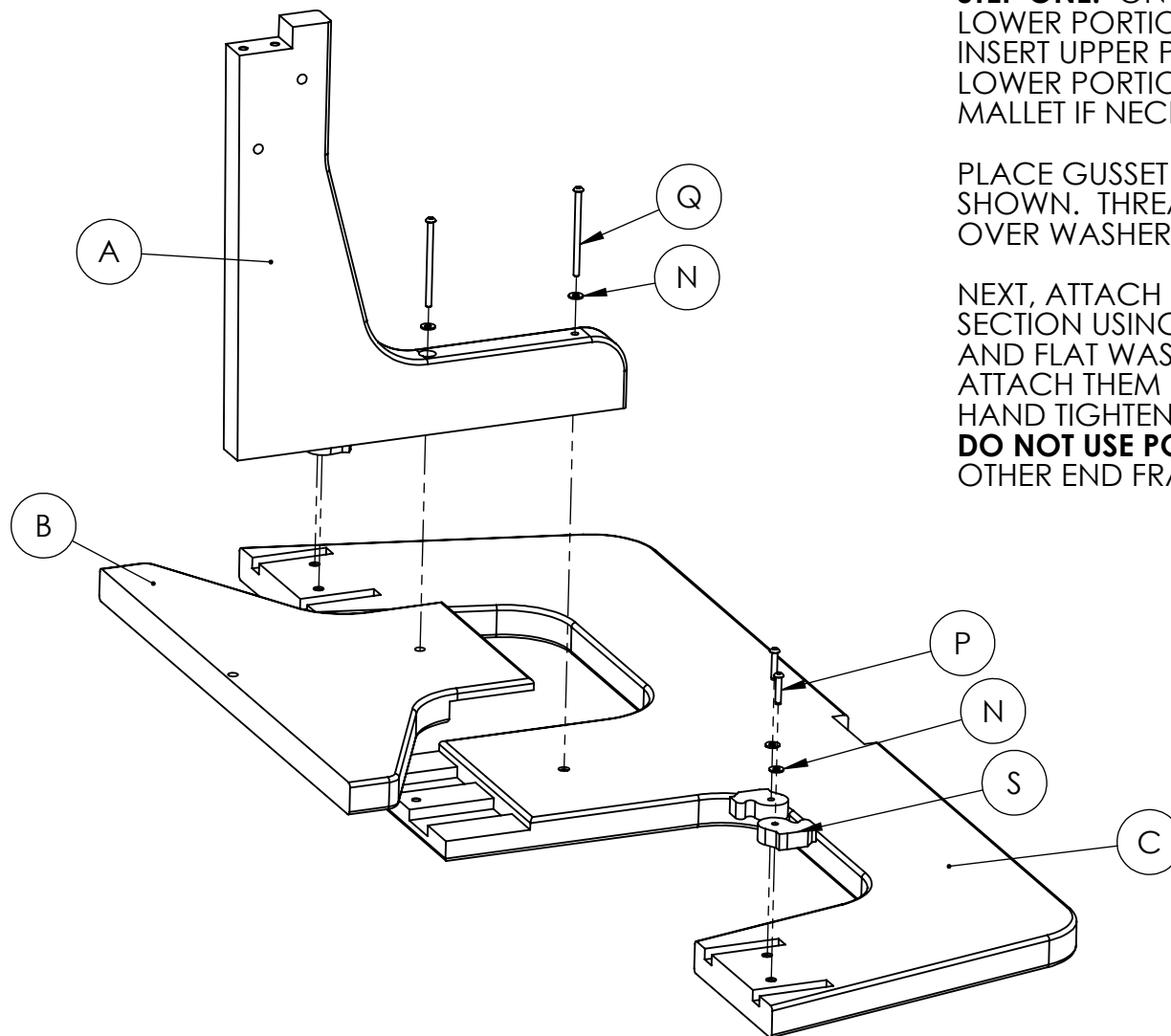

STEP ONE: ON A CLEAN AND LEVEL SURFACE LAY LOWER PORTION OF END FRAME (C) FLAT. INSERT UPPER PORTION OF END FRAME (B) INTO LOWER PORTION. GENTLY TAP WITH RUBBER Mallet IF NECESSARY TO FULLY ENGAGE.

PLACE GUSSET (A) ONTO END FRAME PARTS AS SHOWN. THREAD IN (2) 4" MACHINE SCREWS (Q) OVER WASHERS (N). FULLY TIGHTEN.

NEXT, ATTACH (4) CAMS (S) TO THE LOWER LEG SECTION USING 1-1/4" BUTTON-HEAD SCREW (P) AND FLAT WASHER (N) AS SHOWN. BE SURE TO ATTACH THEM IN THE CORRECT ORIENTATION. HAND TIGHTEN USING ALLEN WRENCH.

DO NOT USE POWER TOOLS! DO THE SAME FOR THE OTHER END FRAME.

PINNACLE 6 FT TABLE INSTRUCTIONS

STEP TWO: WITH THE HELP OF A SECOND PERSON, HOLD BOTH END FRAMES IN THE UPRIGHT POSITION ABOUT 60" APART. LOWER SEAT SUPPORT (F) DOWN INTO SLOTS IN THE END FRAMES. CAMS MAY NEED TO BE ROTATED IN THE POSITION PICTURED BELOW TO SLIDE THE SUPPORTS INTO PLACE. LOOSEN CAM SCREW SLIGHTLY IF THEY DO NOT ROTATE FREELY. GENTLY TAP THE SUPPORTS IN PLACE WITH RUBBER Mallet IF NECESSARY.

WHEN SUPPORTS ARE IN PLACE, ROTATE THE CAMS CLOCKWISE TO LOCK SUPPORTS IN PLACE. TIGHTEN CAM SCREWS USING AN ALLEN WRENCH. HAND TIGHTEN ONLY. **DO NOT USE POWER TOOLS.** REPEAT FOR OTHER SEAT SUPPORT.

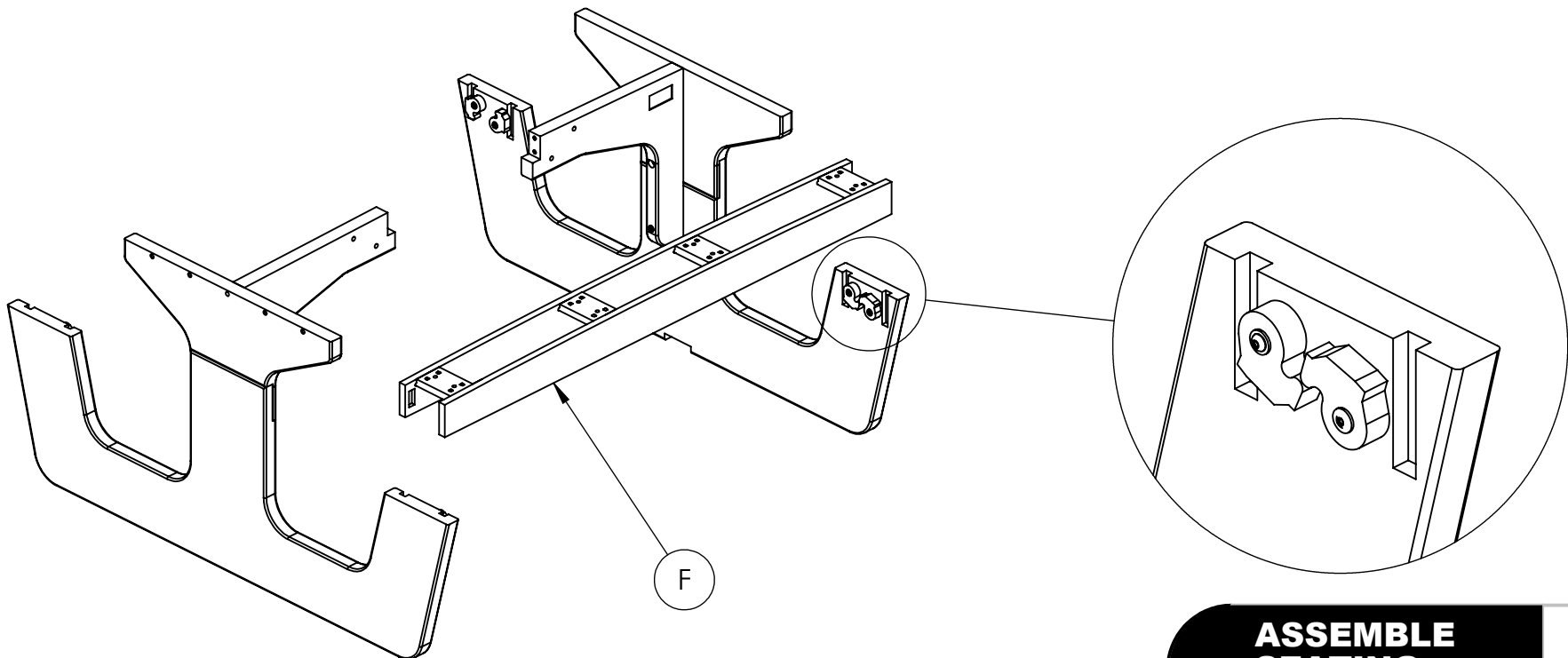

**ASSEMBLE
SEATING
SUPPORT**

5/11

PINNACLE 6 FT TABLE INSTRUCTIONS

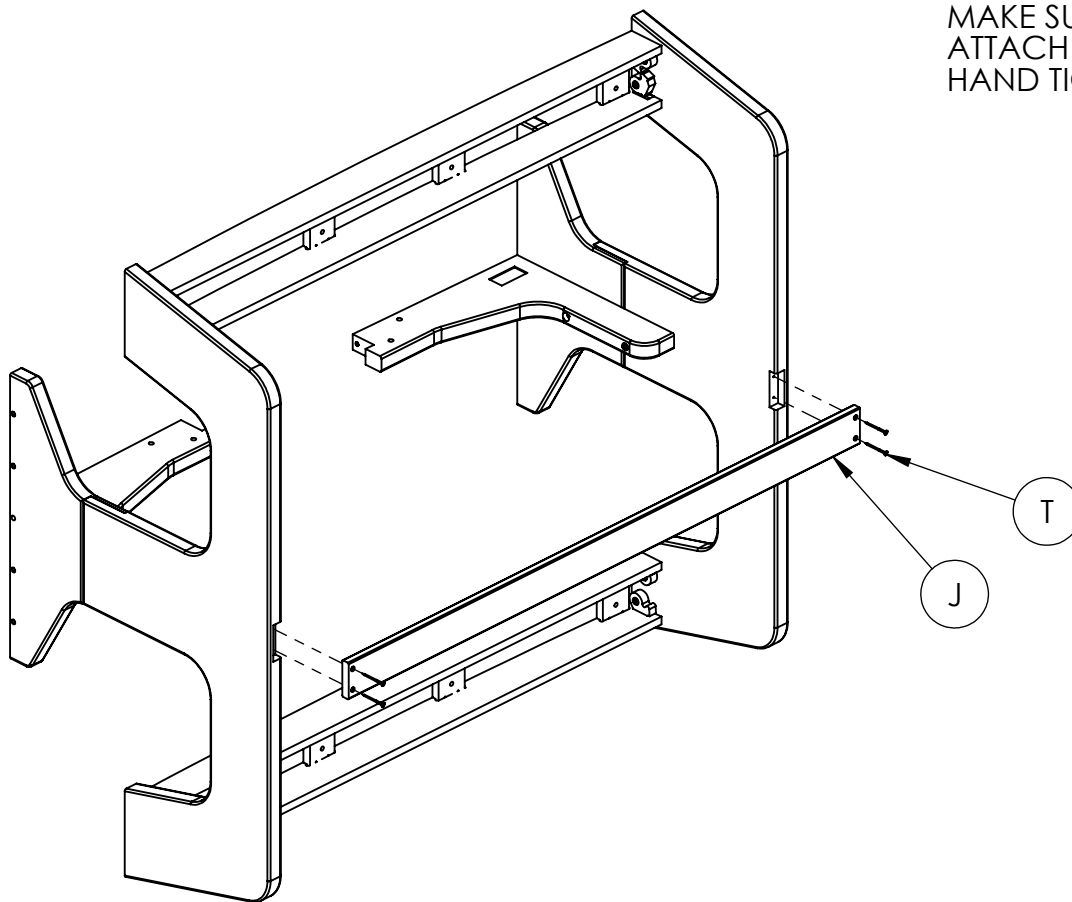

STEP THREE: WITH ANOTHER PERSON HELPING, CAREFULLY TIP THE TABLE UP ON ONE SIDE AS SHOWN. PLACE THE LOWER BRACE (J) INTO THE NOTCHES AT THE LOWER EDGE OF THE END FRAMES. MAKE SURE THE COUNTERBORED HOLES FACE OUT. ATTACH WITH (4) #10 X 2-1/2" FLATHEAD SCREWS (T). HAND TIGHTEN. **DO NOT USE POWER TOOLS.**

PINNACLE 6 FT TABLE INSTRUCTIONS

STEP FOUR: PLACE BRACES (H) INTO NOTCHES IN GUSSETS, MAKING SURE THAT COUNTERBORED HOLES FACE TOWARDS EACH OTHER. ATTACH WITH (4) 1/4-20 x 1-1/2" BUTTON HEAD MACHINE SCREWS (P) AND FLAT WASHERS (N). TIGHTEN BY HAND USING ALLEN WRENCH. **DO NOT USE POWER TOOLS.**

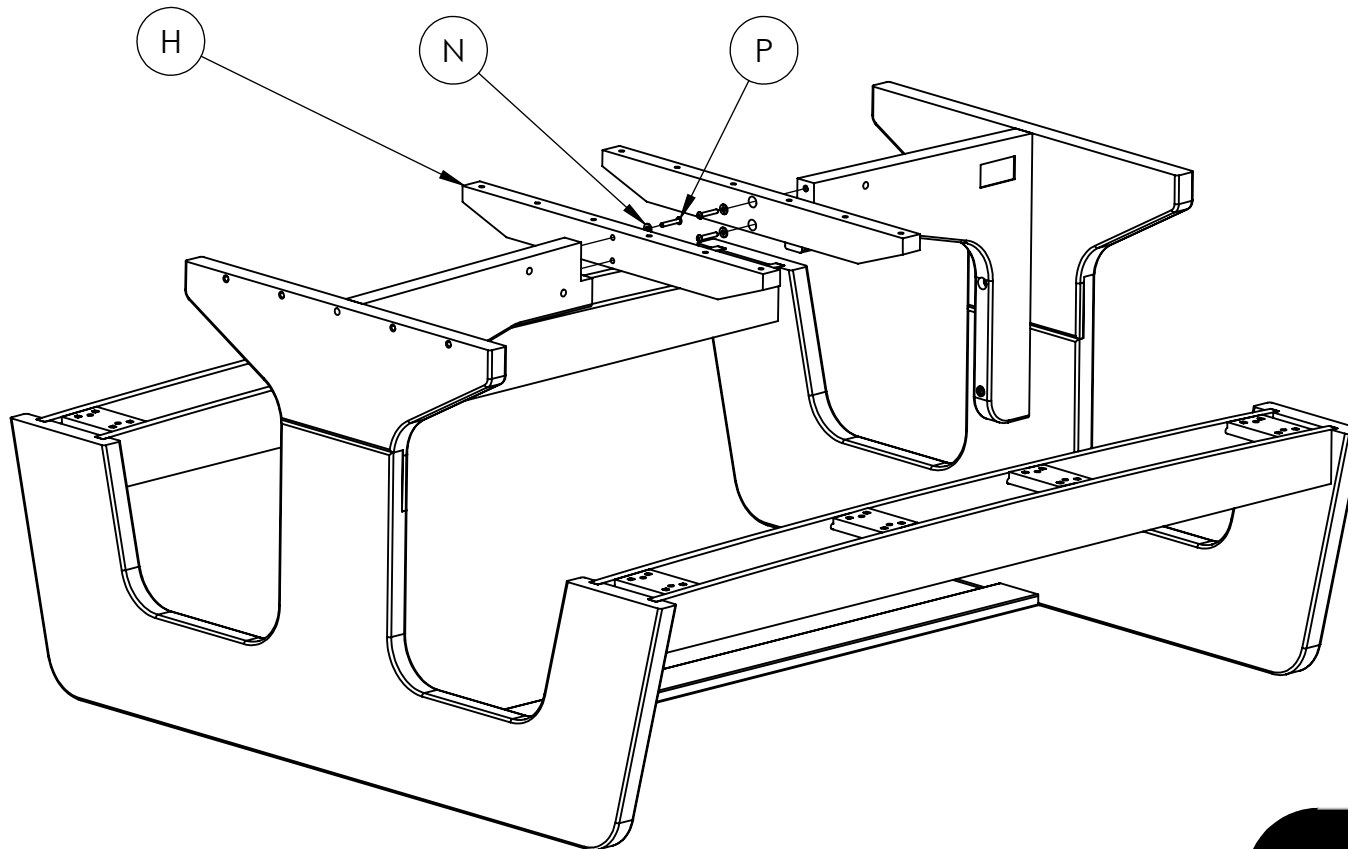

PINNACLE 6 FT TABLE INSTRUCTIONS

STEP FIVE: FIT THE NOTCHED BRACES (G) ONTO THE ONES FROM THE PREVIOUS STEP AS SHOWN. WHILE HOLDING BOTH BRACES IN PLACE WITH ONE HAND, INSERT 3/8" X 4" HEX HEAD BOLT (K) AND FLAT WASHER (L). INSERT ALL 4 BOLTS AND WASHERS. INSERT FLAT WASHERS (L) AND 3/8" LOCKING NUTS (M) ONTO ALL 4 BOLTS. SNUG NUTS DOWN BUT DO NOT FULLY TIGHTEN YET.

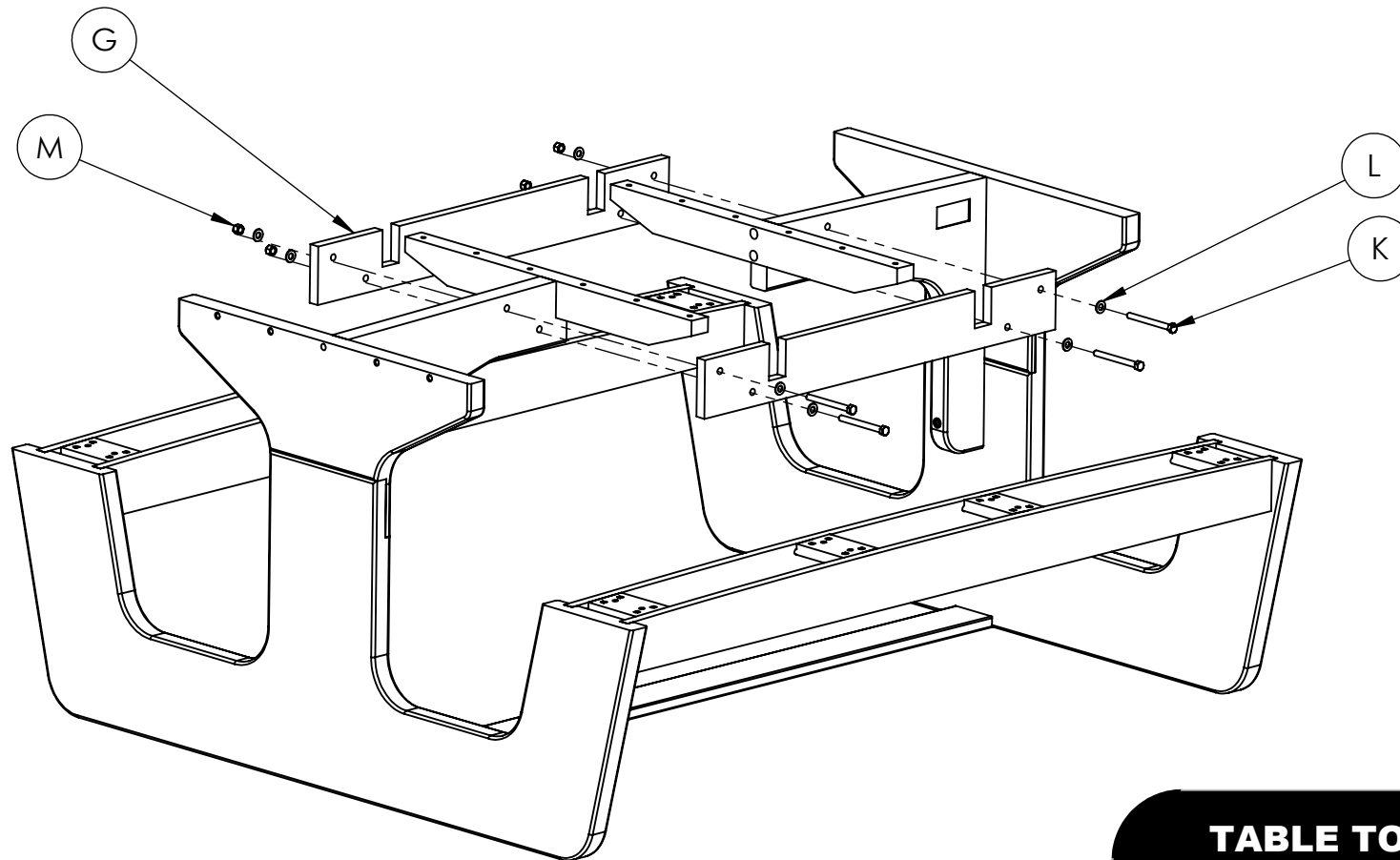

PINNACLE 6 FT TABLE INSTRUCTIONS

STEP SIX: ASSEMBLE THE TOP AS ONE UNIT BEFORE ATTACHING IT TO THE TABLE. LAY SLATS (D) ON CLEAN, LEVEL SURFACE. ATTACH END CLEATS (R) AND CENTER SUPPORTS (H) AS SHOWN USING (8) 1-1/4" BUTTON HEAD SCREWS (P) AND (8) FLAT WASHERS (N) PER SLAT. SNUG THE SCREWS DOWN LIGHTLY BUT DON'T TIGHTEN YET.

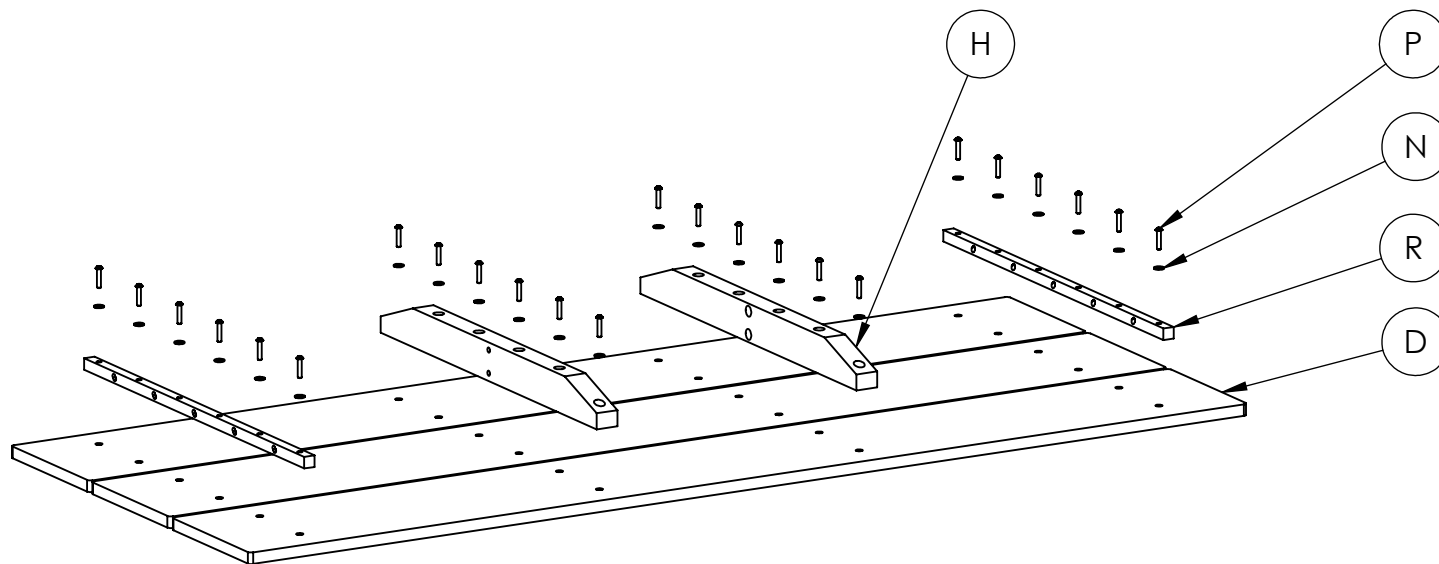

PINNACLE 6 FT TABLE INSTRUCTIONS

STEP SEVEN: PLACE TABLE TOP ASSEMBLY ONTO TABLE. CAREFULLY TAP INTO PLACE WITH A RUBBER Mallet IF NECESSARY TO ALIGN HOLES. START EACH 1/4"-20 MACHINE SCREW (N) OR (R) A FEW THREADS BEFORE GOING BACK TO TIGHTEN ALL OF THEM. THE 3" LONG SCREWS (R) GO IN THE CENTER HOLE ON EACH END. USE 1/4" FLAT WASHERS (N) ON EACH SCREW AS SHOWN.

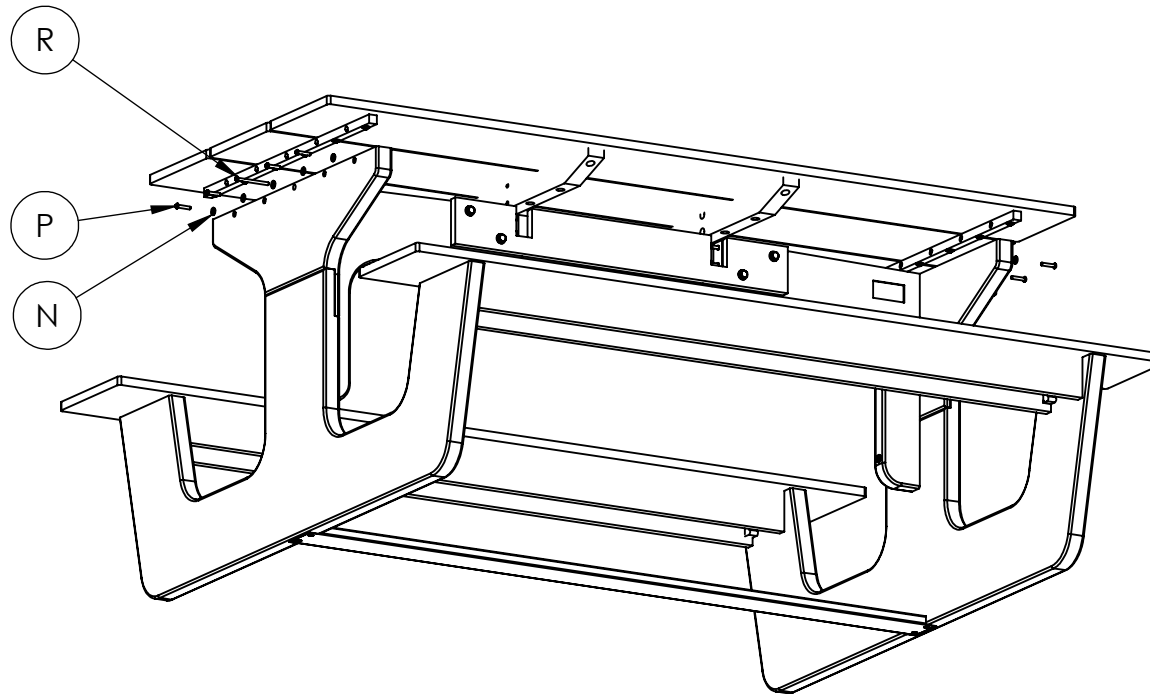

PINNACLE 6 FT TABLE INSTRUCTIONS

STEP EIGHT: ATTACH THE (2) SEAT SLATS (E) USING (8) 1-1/4" SCREWS (P) AND (8) FLAT WASHERS (N) PER SEAT SLAT. **DO NOT USE POWER TOOLS.**

CONGRATULATIONS. YOU HAVE ASSEMBLED YOUR PINNACLE 6 FT TABLE.

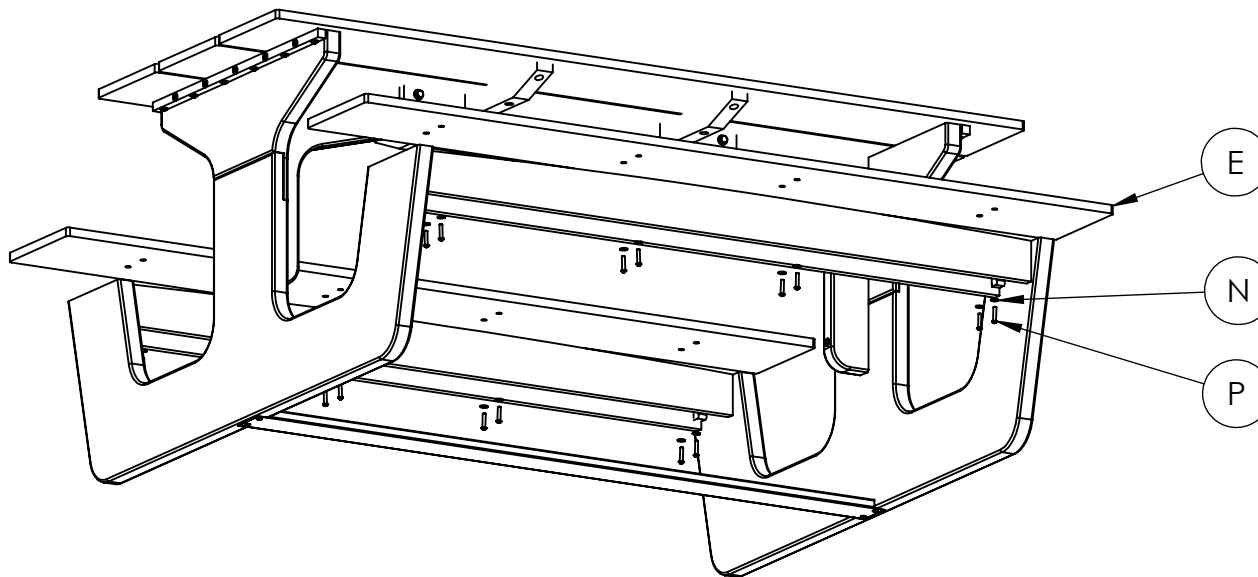

PINNACLE 6 FT TABLE SPECS

REV#1 10/4/22

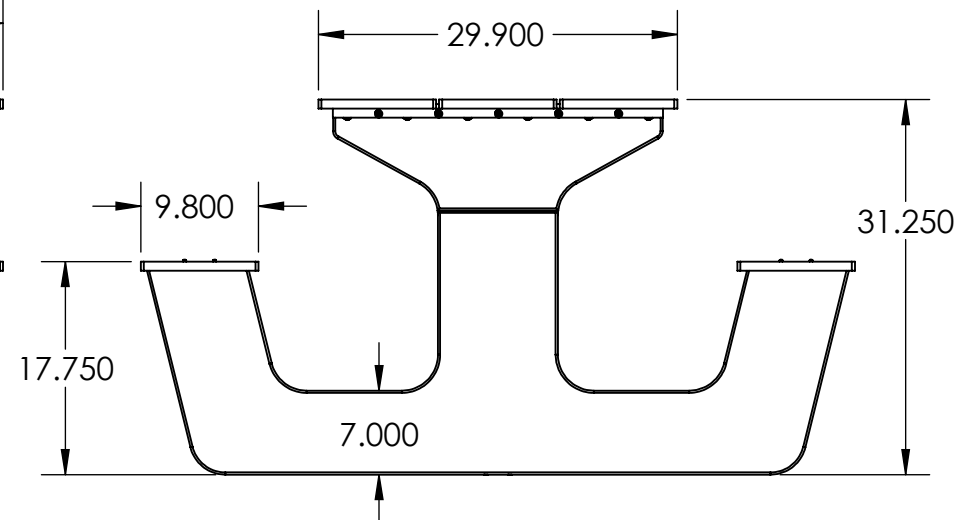
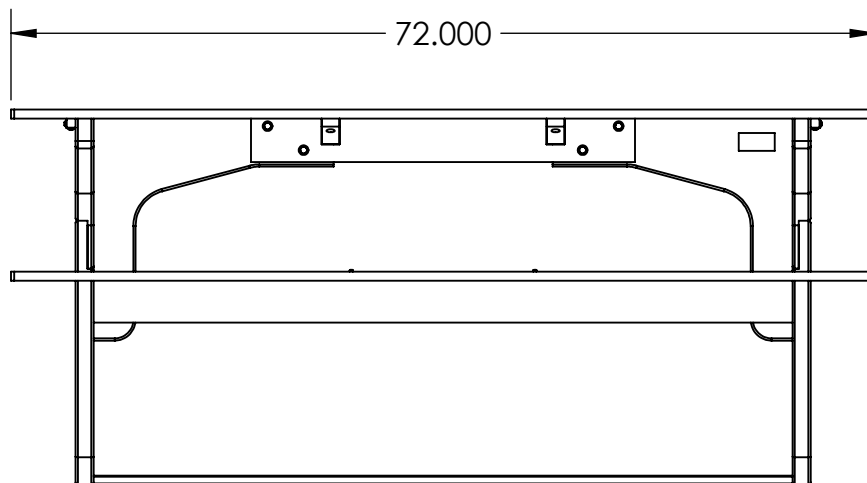
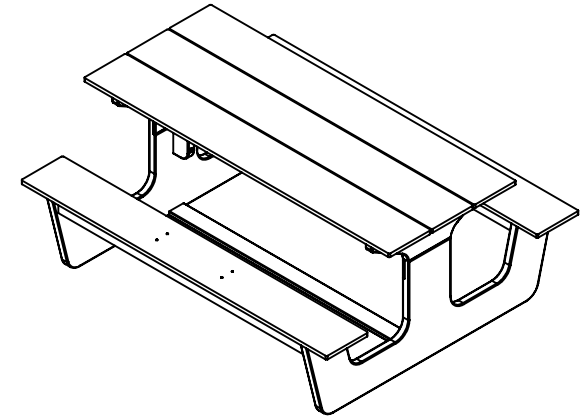

CONSTRUCTION MATERIALS:

Marine Grade Polymer

HARDWARE:

Stainless Steel

ALL DIMENSIONS ARE SHOWN IN INCHES