

PINNACLE 4 FT TABLE INSTRUCTIONS

REV. #1 12/6/22

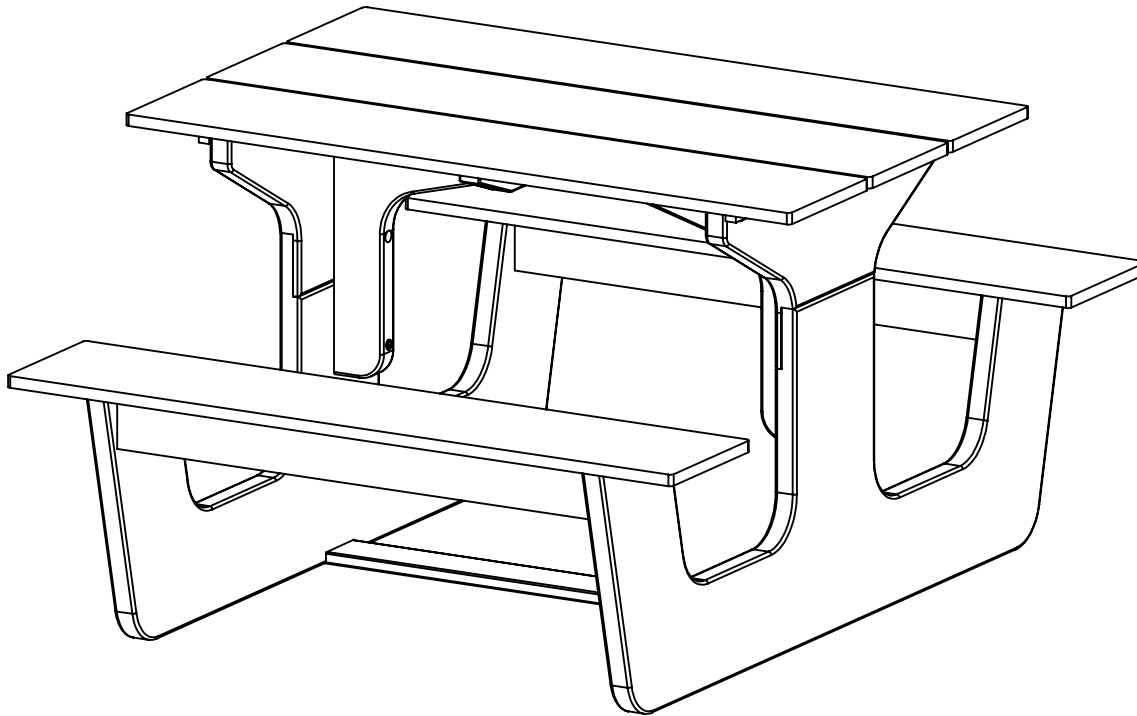

PINNACLE 4 FT TABLE INSTRUCTIONS

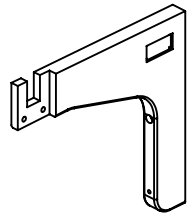

QTY. 2
P/N ATB-P0201

A

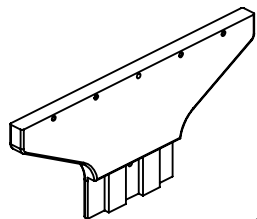

QTY. 2
P/N ATB-P0186

B

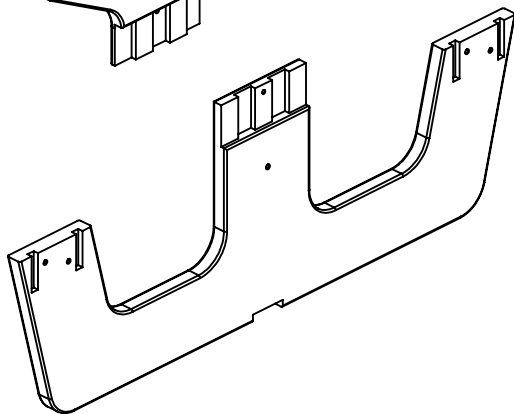

QTY. 2
P/N ATB-P0185

C

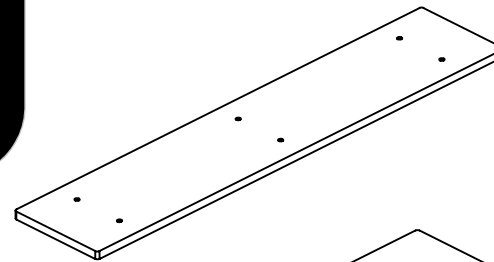

QTY. 3
P/N ATB-P0197

D

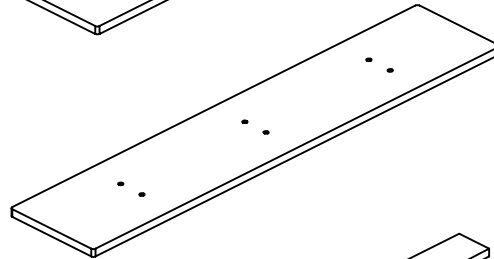

QTY. 2
P/N ATB-P0198

E

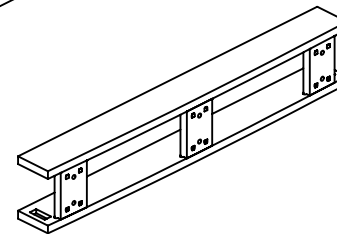

QTY. 2
P/N ATB-A0068

F

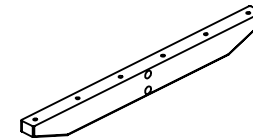

QTY. 1
P/N ATB-P0188

G

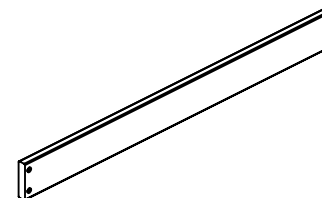

QTY. 1
P/N ATB-P0199

H

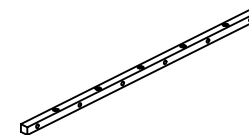

QTY. 2
P/N ATB-P0195

I

REQUIRED TOOLS (NOT INCLUDED)

1 - 9/16" WRENCH

1 - 9/16" SOCKET

1 - RUBBER Mallet

1 - #2 SQUARE DRIVE BIT

1 - 6mm ALLEN WRENCH

**PARTS
REQUIRED**

2/10

PINNACLE 4 FT TABLE INSTRUCTIONS

QTY. 2
3/8" X 2-1/2" HEX BOLT

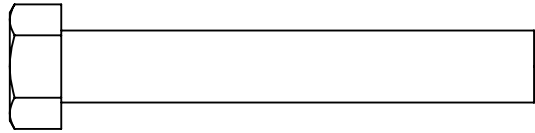
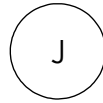

QTY. 4
3/8" FLAT WASHER

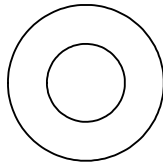
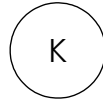

QTY. 2
3/8" LOCKING NUT

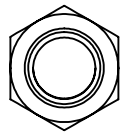
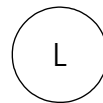

QTY. 52
1/4" FLAT WASHER

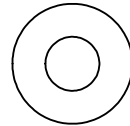
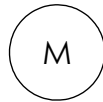

QTY. 46
1/4"-20 X 1-1/4", BUTTON
HEAD MACHINE SCREW

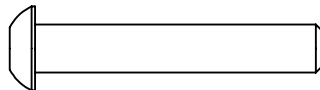

QTY. 4
1/4"-20 X 4" BUTTON
HEAD MACHINE SCREW

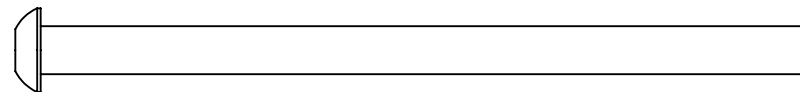
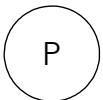

QTY. 2
1/4"-20 X 3" BUTTON
HEAD MACHINE SCREW

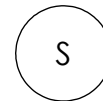
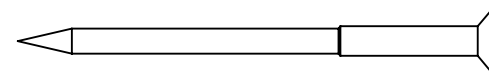
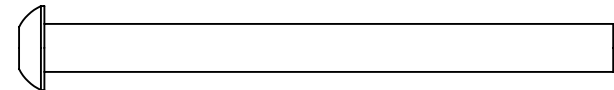
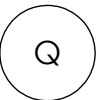

QTY. 4
DECK SCREW

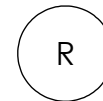

QTY. 8
CAMS

PINNACLE 4 FT TABLE INSTRUCTIONS

STEP ONE: ON A CLEAN AND LEVEL SURFACE LAY LOWER PORTION OF END FRAME (C) FLAT. INSERT UPPER PORTION OF END FRAME (B) INTO LOWER PORTION. GENTLY TAP WITH RUBBER Mallet IF NECESSARY TO FULLY ENGAGE.

PLACE GUSSET (A) ONTO END FRAME PARTS AS SHOWN. THREAD IN (2) 4" MACHINE SCREWS (P) OVER WASHERS (M). FULLY TIGHTEN (P).

NEXT, ATTACH (4) CAMS TO THE LOWER LEG SECTION USING 1-1/4" MACHINE SCREW (N) AND FLAT WASHER (M) AS SHOWN. BE SURE TO ATTACH THEM IN THE CORRECT ORIENTATION. HAND TIGHTEN USING ALLEN WRENCH. **DO NOT USE POWER TOOLS!** DO THE SAME FOR THE OTHER END FRAME.

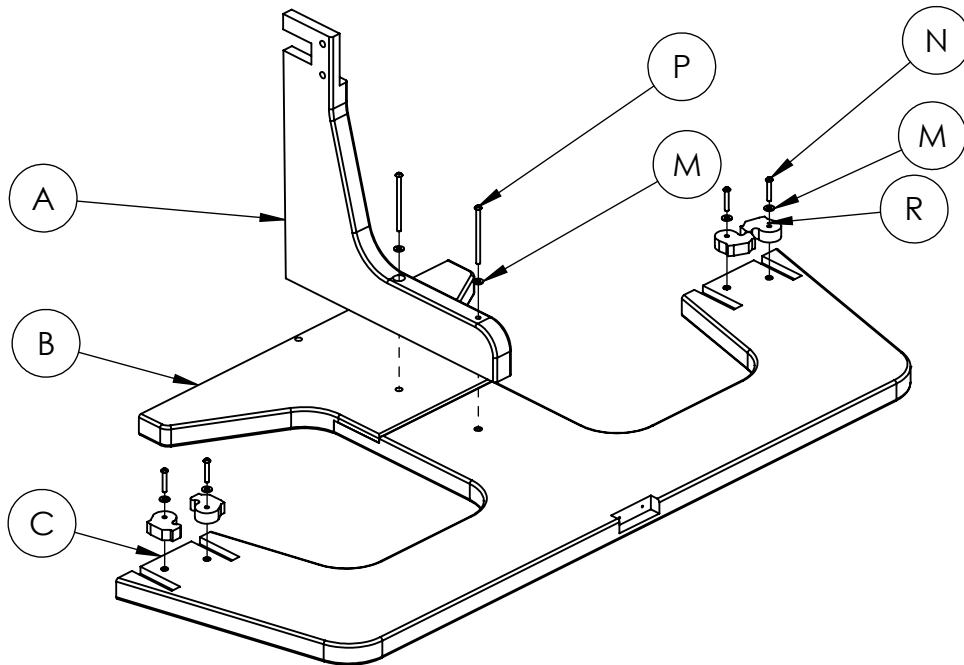

PINNACLE 4 FT TABLE INSTRUCTIONS

STEP TWO: WITH THE HELP OF A SECOND PERSON, HOLD BOTH END FRAMES IN THE UPRIGHT POSITION ABOUT 36" APART. LOWER SEAT SUPPORT (F) DOWN INTO SLOTS IN THE END FRAMES. CAMS MAY NEED TO BE ROTATED IN THE POSITION PICTURED BELOW TO SLIDE THE SUPPORTS INTO PLACE. LOOSEN CAM SCREW SLIGHTLY IF THEY DO NOT ROTATE FREELY. GENTLY TAP THE SUPPORTS IN PLACE WITH A RUBBER Mallet IF NECESSARY.

WHEN SUPPORT IS IN PLACE, ROTATE THE CAMS CLOCKWISE TO LOCK SUPPORTS IN PLACE. TIGHTEN CAM SCREWS USING AN ALLEN WRENCH. HAND TIGHTEN ONLY. **DO NOT USE POWER TOOLS.** REPEAT FOR THE OTHER SEAT SUPPORT.

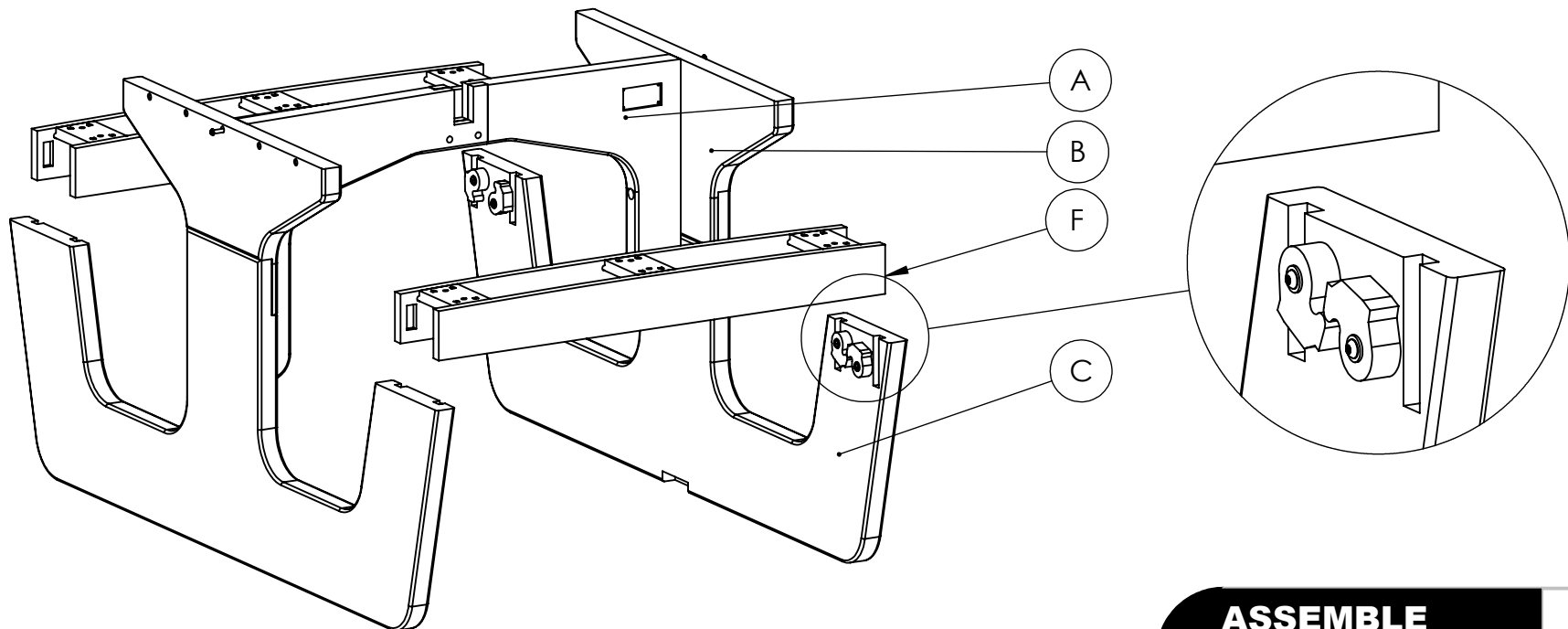

**ASSEMBLE
SEATING
SUPPORT**

5/10

PINNBACLE 4 FT TABLE INSTRUCTIONS

STEP THREE: ATTACH THE ENDS OF THE TWO GUSSETS (A) TO EACH OTHER USING 3/8" BOLTS (J), FLAT WASHERS (K), AND LOCKING NUTS (L). RUN NUT ONTO BOLT BUT DO NOT TIGHTEN FULLY YET.

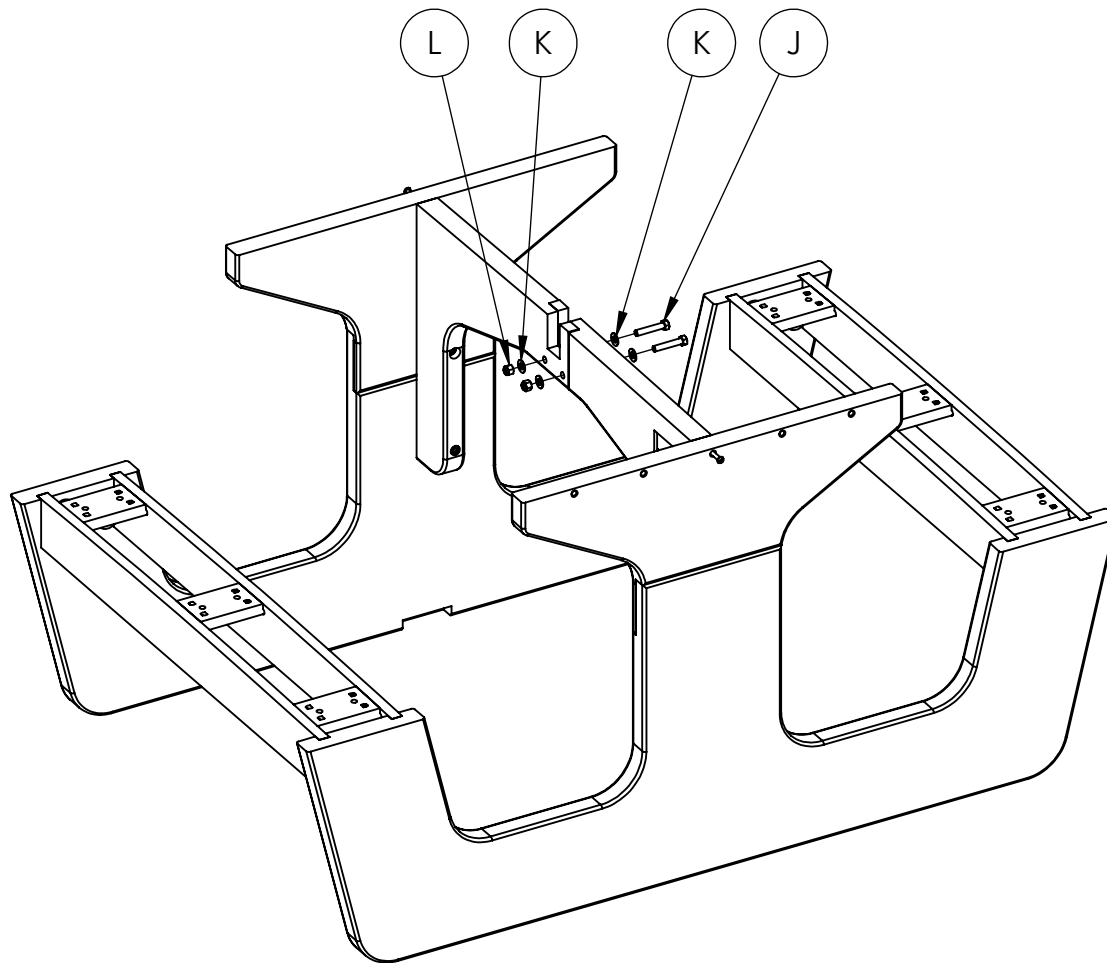

**ATTACHING
GUSSETS TO
EACH OTHER**

6/10

PINNACLE 4 FT TABLE INSTRUCTIONS

STEP FOUR: WITH HELP FROM ANOTHER PERSON, ROLL THE TABLE UP ONTO ONE OF IT'S ENDS. WITH ONE PERSON HOLDING THE TABLE STEADY, ATTACH THE LOWER LEG BRACE INTO THE NOTCHES AT THE LOWER EDGE OF THE END FRAMES. MAKE SURE THE COUNTERSUNK HOLES FACE OUT. ATTACH USING (4) #10 X 2-1/2" FLATHEAD SCREWS (S). HAND TIGHTEN. **DO NOT USE POWER TOOLS.**

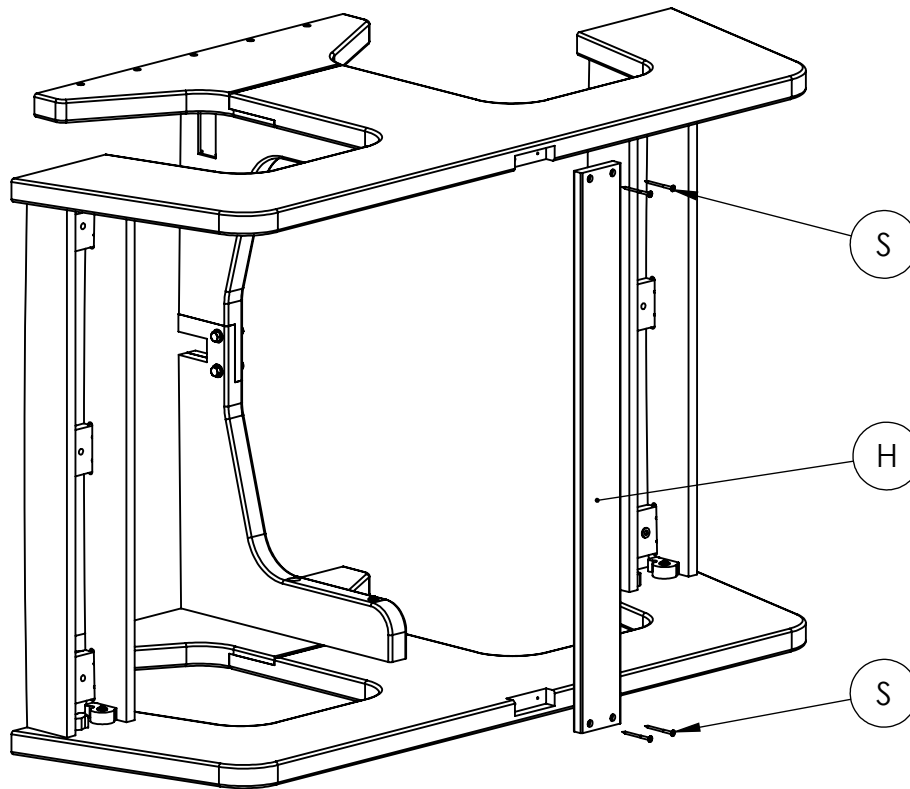

**ATTACHING LOWER
LEG BRACE**

7/10

PINNACLE 4 FT TABLE INSTRUCTIONS

STEP FIVE: ASSEMBLE THE TOP AS ONE UNIT BEFORE ATTACHING IT TO THE TABLE. LAY SLATS (D) ON CLEAN, LEVEL SURFACE. ATTACH END CLEATS (I) AND CENTER SUPPORT (G) AS SHOWN USING (6) 1-1/4" BUTTON HEAD SCREWS (N) AND (6) FLAT WASHERS (M) PER SLAT. SNUG THE SCREWS DOWN LIGHTLY BUT DON'T TIGHTEN YET.

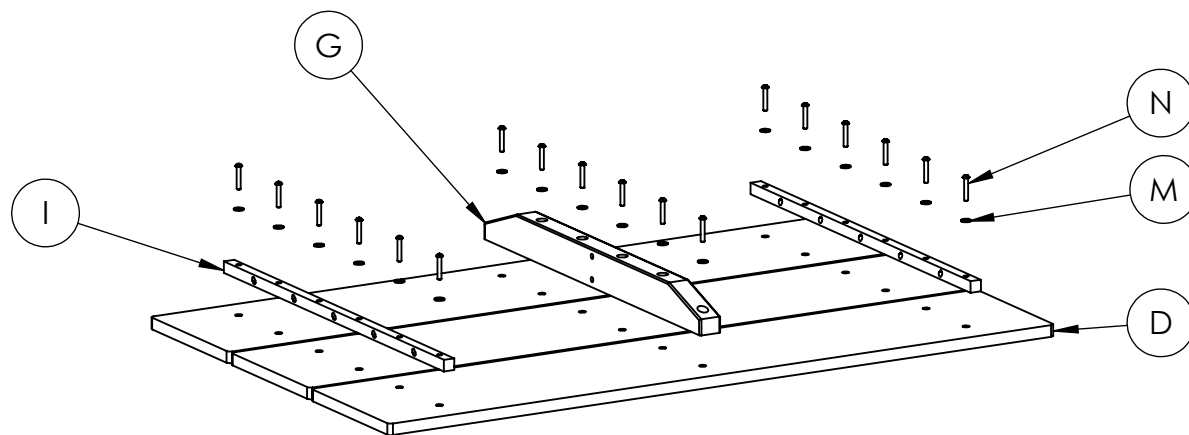

PINNACLE 4 FT TABLE INSTRUCTIONS

STEP SIX: PLACE TABLE TOP ASSEMBLY ONTO TABLE. CAREFULLY TAP INTO PLACE WITH A RUBBER Mallet IF NECESSARY TO ALIGN HOLES. START EACH 1/4"-20 MACHINE SCREW (N) OR (P) A FEW THREADS BEFORE GOING BACK TO TIGHTEN ALL OF THEM. USE 1/4" FLAT WASHER (M) WITH EACH SCREW AS SHOWN.

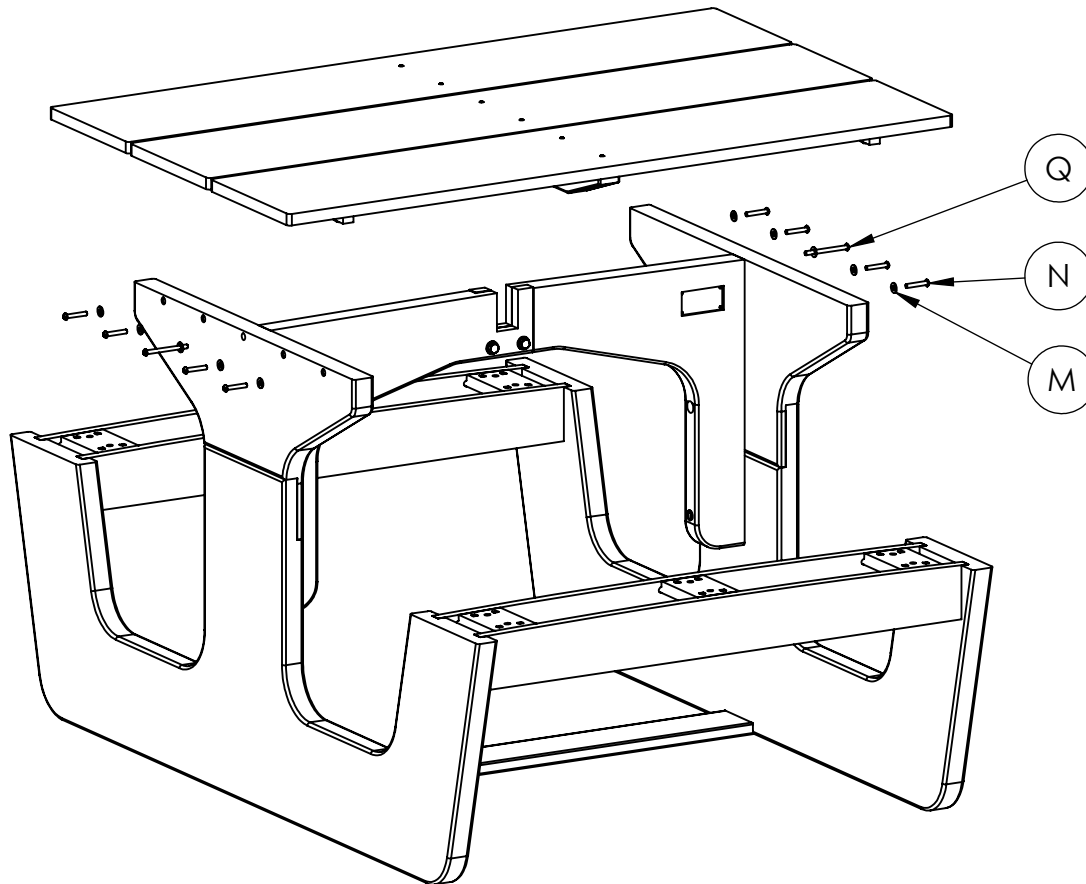

**ATTACH TOP
TO TABLE**

9/10

PINNACLE 4 FT TABLE INSTRUCTIONS

STEP SEVEN: ATTACH THE (2) SEAT SLATS (D) USING (12) 1-1/4" SCREWS (N) AND (12) FLAT WASHERS (M). GO BACK AND CONFIRM ALL SCREWS ARE FULLY TIGHTENED. **NO NOT USE POWER TOOLS.**

CONGRATULATIONS. YOU HAVE ASSEMBLED YOUR PINNACLE 4 FT TABLE.

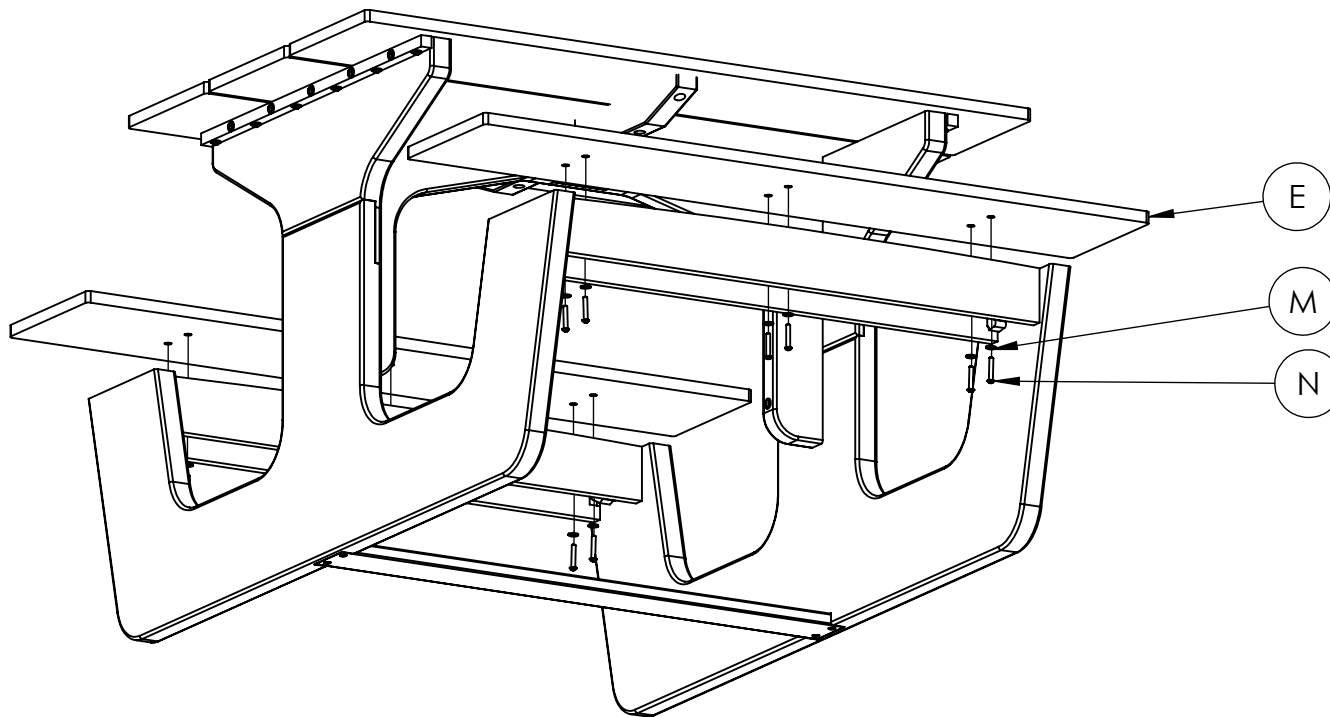

**ATTACH SEATING
SLATS**

10/10

PINNACLE 4 FT TABLE INSTRUCTIONS

REV. #1 10/4/22

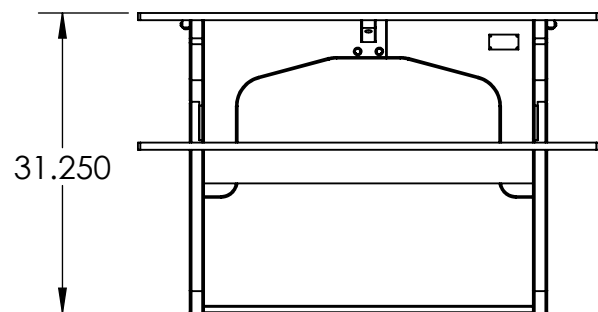
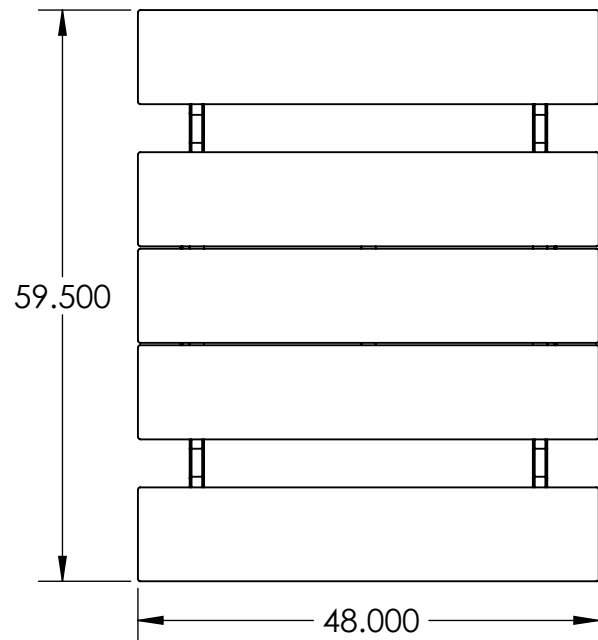

CONSTRUCTION MATERIALS:

Marine Grade Polymer

HARDWARE:

Stainless Steel

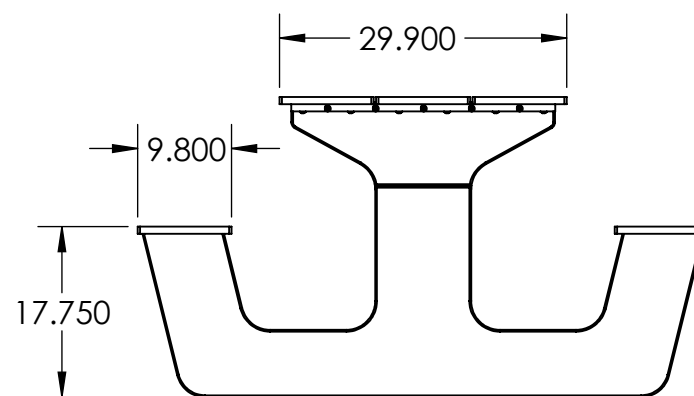
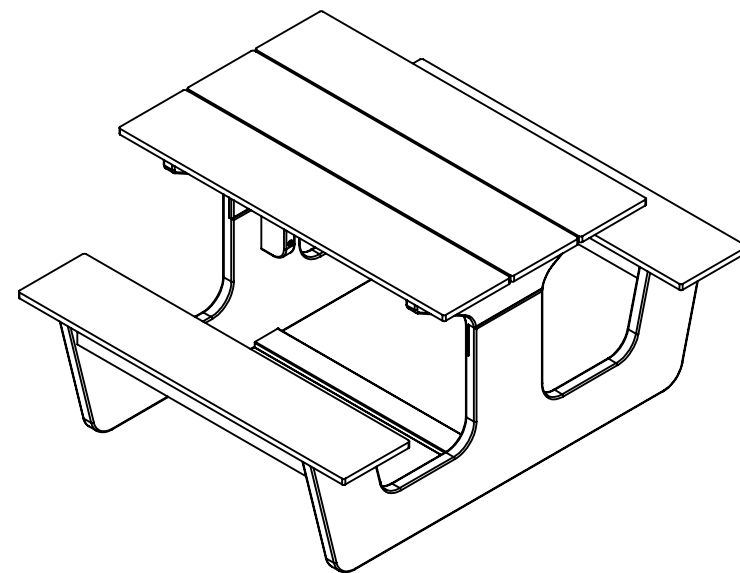

ALL DIMENSIONS ARE SHOWN IN INCHES